

Valvole rotative DT_ - Rotary valves DT_

A passaggio verticale 1bar - Drop-thru 1bar

- Minime perdite di trafilamento
Minimum gas leakage
- Costruzione robusta
Heavy duty construction
- Entrata angolata
Sheared angle inlet
- Entrata ed uscita di grandi dimensioni senza restringimento
Large inlet and outlet without hindrance
- Versioni certificate ATEX 94/9/EC
Versions in accordance with ATEX 94/9/EC



 A passaggio verticale
Drop-thru

Applicazione <i>Application</i>	Alimentatori di materiali in polvere in sistemi di trasporto pneumatico o scaricatori e dosatori sotto silii e tramogge.	<i>Volumetric feeders for powders in pneumatic conveying systems or discharger and metering valves below silos and hoppers.</i>
Dimensioni <i>Size</i>	4, 6, 8, 10, 12, 16 da 2 a 102 Litri/giro	4, 6, 8, 10, 12, 16 2 to 102 Litres/rev.
Pressione <i>Pressure range</i>	Fino a 1bar di pressione differenziale	<i>Up to 1bar differential pressure</i>
Temperatura <i>Temperature</i>	Fino a 40°C Versioni per alte temperature fino a 350°C	<i>Up to 40°C High temperature versions up to 350°C</i>
Materiali di costruzione <i>Construction materials</i>	<ul style="list-style-type: none"> ■ Corpo e coperchi Fusioni di Ghisa, Acciaio inossidabile, Alluminio ■ Rotore Acciaio al carbonio, acciaio inossidabile ■ Estremità delle pale Acciaio antiusura, acciaio inossidabile ■ Trattamenti superficiali interni Nichelatura chimica, cromatura dura ■ Finiture superficiali Vari gradi di finiture disponibili 	<ul style="list-style-type: none"> ■ <i>Body and end covers</i> <i>Cast iron, Cast stainless steel, Cast aluminium</i> ■ <i>Rotor</i> <i>Carbon steel, stainless steel</i> ■ <i>Replaceable blade tips</i> <i>Hardened steel, stainless steel</i> ■ <i>Internal surface treatments</i> <i>Nickel-plating, hard chrome-plating</i> ■ <i>Surface finish</i> <i>Various grades available</i>

Valvole rotative DT_ - Rotary valves DT_

Caratteristiche - Design features

Entrata angolata

Per un funzionamento dolce e senza contraccolpi

Sheared angle inlet

Ensure gentle product handling and smooth operation

Trasmissione diretta o a catena
Direct drive or chain drive

Resistenza a pressioni interne fino a **10bar** per l'utilizzo in aree con atmosfere potenzialmente esplosive.
Versioni certificate **ATEX 94/9/EC**

Pressure-surge resistant up to 10 bar suitable for use in areas which represent an explosion hazard.
Versions in accordance with **ATEX 94/9/EC**

Basse perdite di trafilamento e alta efficienza di riempimento grazie a minimi giochi interni ed a rotor con 10 o 12 pale.
Versioni a smontaggio rapido per una facile pulizia interna

Minimal gas leakage loss and greater filling efficiency due to close clearances and 10 or 12 vanes rotors.
Fast opening versions for easy internal cleaning.

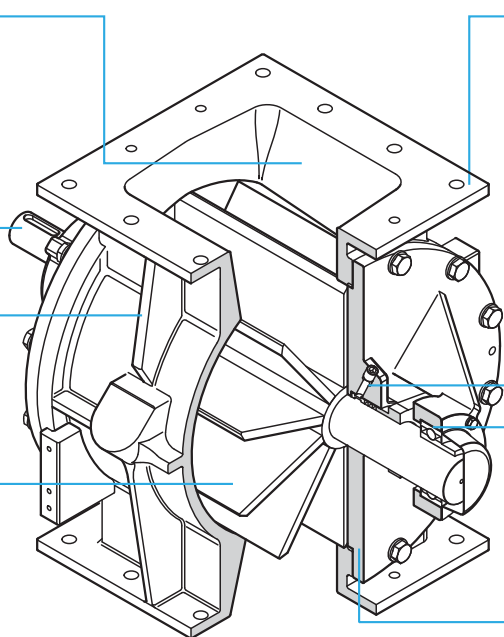

Robusto corpo in fusione con entrata ed uscita di grandi dimensioni senza restringimento

Heavy duty cast body with large inlet and outlet without hindrance

Tenuta flussata, nessun deposito di materiale all'interno della tenuta. Disponibile anche con tenuta a premibaderna o a grasso

Air purge type seal, no deposit or dirty around the seal
Packing gland or grease type seals available on request

Cuscinetti stagni ingrassati a vita, montati esternamente, consentono utilizzi con alte temperature e non sono a contatto con il materiale

Outboard mounted sealed ball bearings, with lifetime grease fill, facilitate use at high temperature and preclude product ingress

Perfetta tenuta tramite O-ring tra corpo e coperchi

Air-tight with O-ring on end cover

Dati tecnici - Technical data

Diagrammi Diagrams

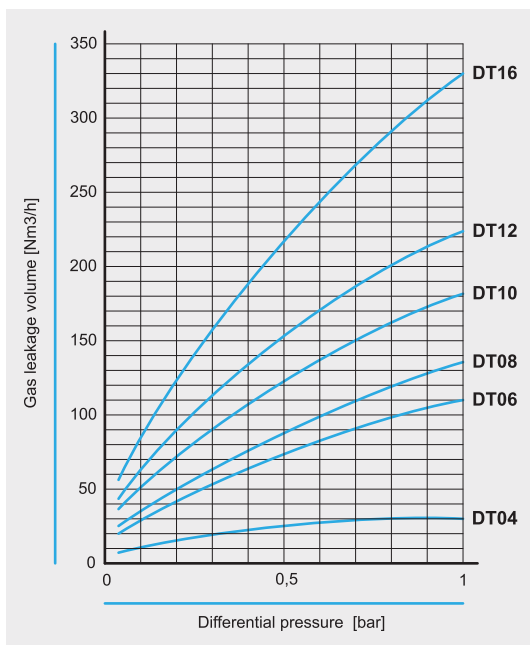

■ Diagramma delle perdite di trafilamento
Gas leakage diagram

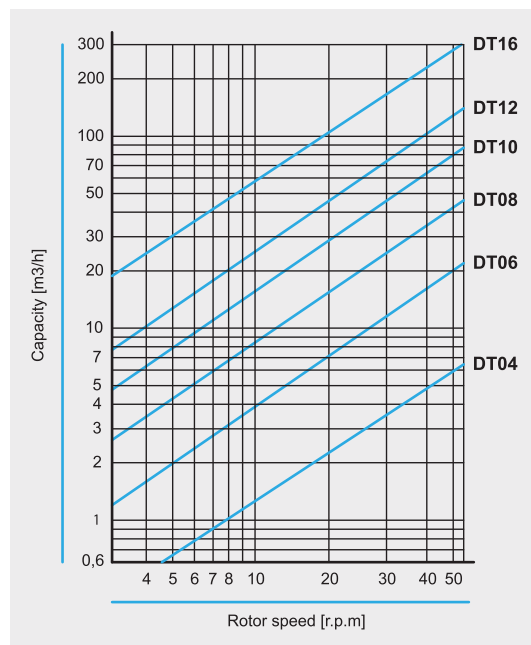

■ Diagramma delle portate (Riempimento al 100%)
Capacity diagram (Filling efficiency 100%)

Rotori ed accessori - Rotors and accessories

Rotori Rotors

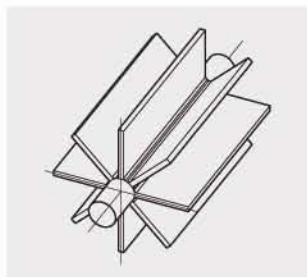

■ **Rotore A (Standard)** Rotore aperto
Rotor A (Standard) Open end rotor

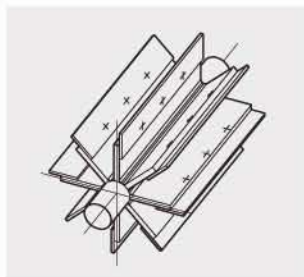

■ **Rotore D** Rotore aperto con
estremità delle pale sostituibili
*Rotor D Open end rotor with
replaceable blade tips*

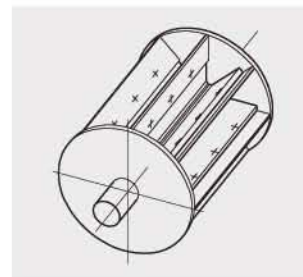

■ **Rotore DS** Rotore chiuso con
estremità delle pale sostituibili
*Rotor DS Closed end rotor with
replaceable blade tips*

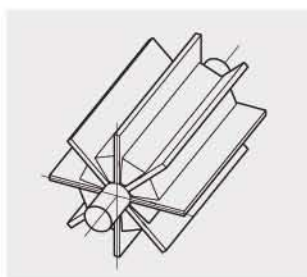

■ **Rotori parzialmente riempiti**
Partially filled rotors



■ **Rotori con tasche raccordate**
Rotors with radiused pockets

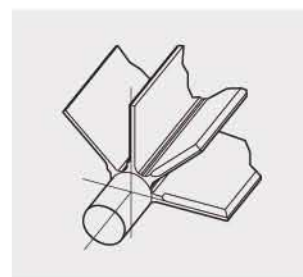

■ **Rotori con pale smussate**
Rotors with beveled edge blades

Accessori Accessories

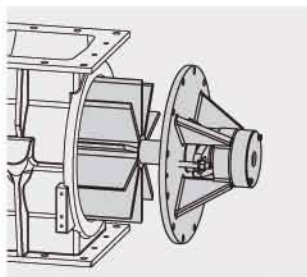

■ **Versione a smontaggio rapido**
Fast opening version (page 35)

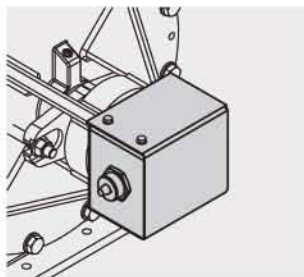

■ **Controllo di rotazione**
Motion indicator

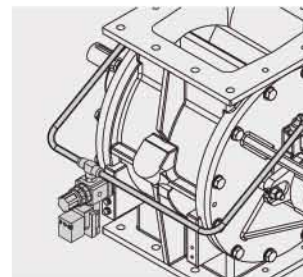

■ **Sistema di flussaggio delle tenute**
Shaft seals air purge system

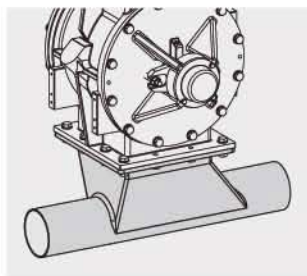

■ **Iniettore per trasporti pneumatici**
*Pneumatic conveying manifold
(page 41)*

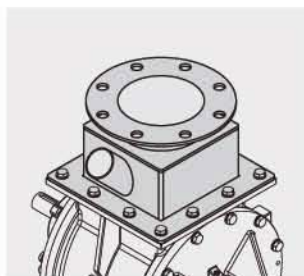

■ **Sistema di sfiato AVS**
Air vent system AVS (page 43)

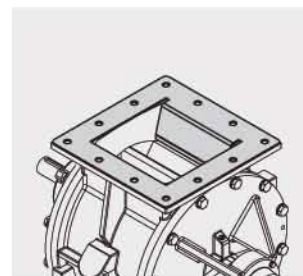

■ **Entrata a deflettore**
Inlet material deflector

Valvole rotative DTC - Rotary valves DTC

Dimensioni - Dimensions

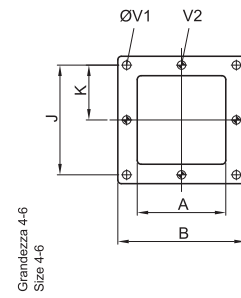
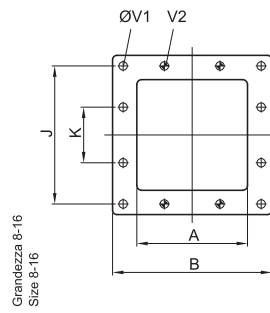
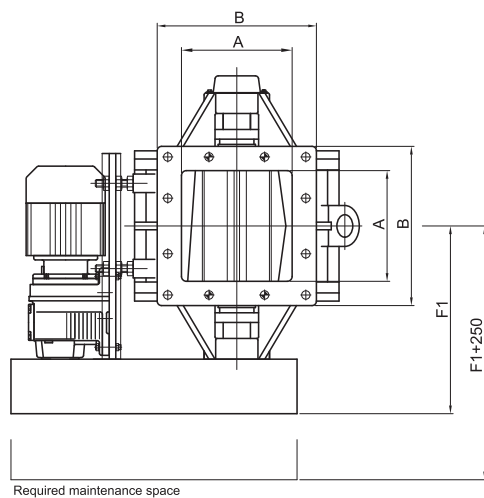
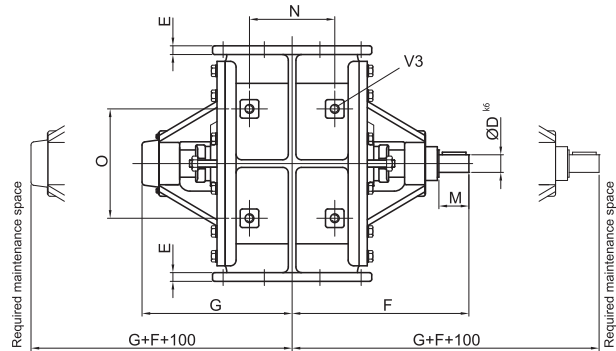
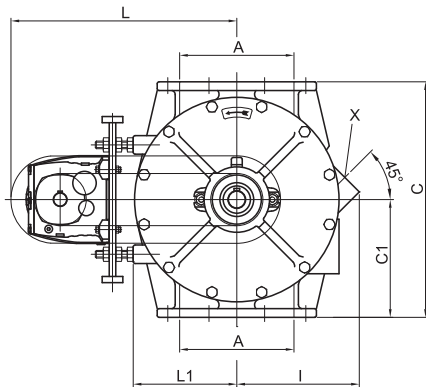

	Ltr/rev Ltr/giro	A	B	C ³⁾	C1 ³⁾	Ø D ^{k6}	E	F	F1	G	I
DTC04	2	100	190	251	125,5	25	14	253	286	207	117
DTC06	8	150	260	355	177,5	30	14	294,5	319	247	183
DTC08	14	200	310	432	216	35	16	330	344	272	221
DTC10	28	250	375	508	254	35	16	355	370	297	262
DTC12	43	300	425	558	279	42	18	398	402	335	287
DTC16	102	380	508	710	355	42	20	449	453	386	366

	L	L1	M	N	O	J	K	Ø V1	V2	V3	X	kg ¹⁾
DTC04	349	116	50	82	135	159	79,5	14	M12	M12	G1"	70
DTC06	444	173	50	112	190	210	105	14	M12	M16	G1 1/2"	145
DTC08	444	192	60	180	210	260	90	14	M12	M16	G1 1/2"	200
DTC10	522	236	60	252	280	324	108	14	M12	M16	G1 1/2"	270
DTC12	587	262	65	304	320	380	130	14	M12	M16	2 x G1 1/2"	380
DTC16	668	344	65	370	340	458	158	16	M14	M20	2 x G1 1/2"	500

1) Peso approssimativo
Weight approx

2) Opzionale: Foro di sfiato
Option: Body vent opening

3) Misure valide solo per valvole in ghisa
Measurements only valid for valves in cast iron

Valvole rotative DTM - Rotary valves DTM

Dimensioni - Dimensions

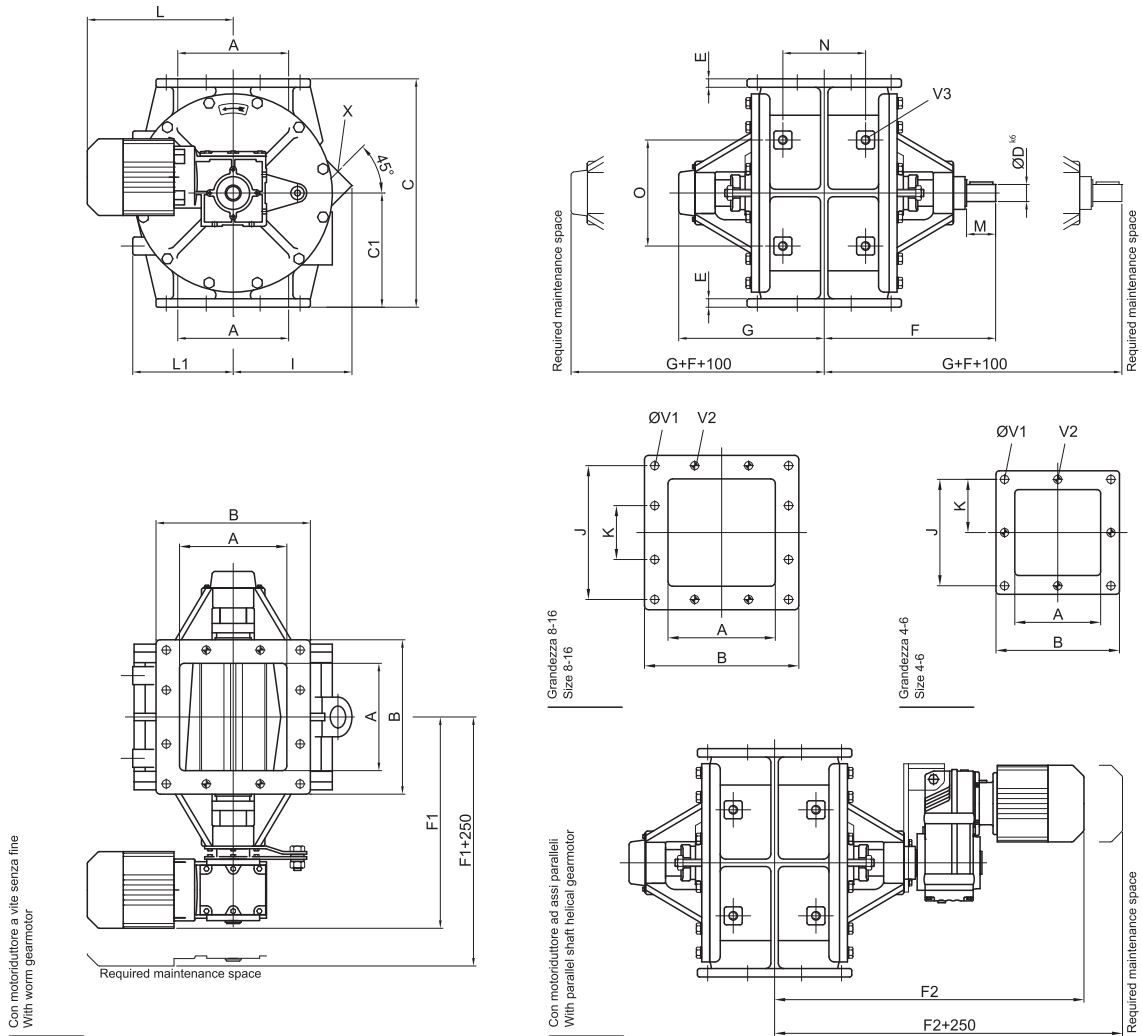

	Ltr/rev Ltr/giro	A	B	C ⁴⁾	C1 ⁴⁾	Ø D ^{k6 1)}	E	F	F1	F2	G	I
DTM04	2	100	190	251	125,5	25	14	253	324	489	207	117
DTM06	8	150	260	355	177,5	30	14	294,5	404	610	247	183
DTM08	14	200	310	432	216	35	16	330	440	659	272	221
DTM10	28	250	375	508	254	35	16	355	465	684	297	262
DTM12	43	300	425	558	279	42	18	398	510	750	335	287
DTM16	102	380	508	710	355	42	20	449	561	816	386	366

	L	L1	M	N	O	J	K	Ø V1	V2	V3	X ³⁾	kg ²⁾
DTM04	289	116	50	82	135	159	79,5	14	M12	M12	G1"	65
DTM06	349	173	50	112	190	210	105	14	M12	M16	G1 1/2"	135
DTM08	361	192	60	180	210	260	90	14	M12	M16	G1 1/2"	190
DTM10	361	236	60	252	280	324	108	14	M12	M16	G1 1/2"	260
DTM12	404	262	65	304	320	380	130	14	M12	M16	2 x G1 1/2"	360
DTM16	428	344	65	370	340	458	158	16	M14	M20	2 x G1 1/2"	480

1) Misure non valide per motoriduttore ad assi paralleli
Measurements not valid for parallel shaft helical gearmotor

2) Peso approssimativo
Weight approx

3) Opzionale: Foro di sfianto
Option: Body vent opening

4) Misure valide solo per valvole in ghisa
Measurements only valid for valves in cast iron

Altri prodotti YOUNG-MASSA - Other YOUNG-MASSA products



DC_
Valvole rotative – 0,1 bar
Rotary valves – 0,1 bar



DT_
Valvole rotative – 1 bar
Rotary valves – 1 bar



DR_
Valvole rotative DIN PN10 – 1 bar
Rotary valves DIN PN10 – 1 bar



BT_
Valvole rotative a flusso attraversato – 1 bar
Blow-thru rotary valves – 1 bar



SE_
Valvole rotative per granuli – 1 bar
Rotary valves for pellets – 1 bar



DRS_, DTS_, BTS_
A smontaggio rapido per facile pulizia interna
Fast opening for easy internal cleaning



DRZ_, DTZ_, BTZ_
A smontaggio rapido con guide di estrazione
Fast opening with supporting bars

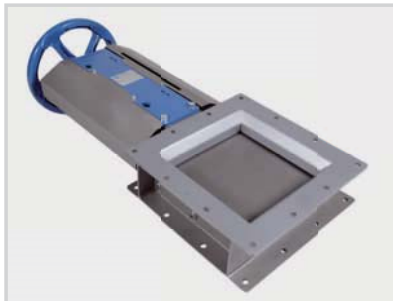

VP_, VPH_
Valvole a ghigliottina
Slides Valves



SA_
Valvole a doppio clapet
Double flap gate valves



C_, S_, F_, V_, VF_
Scaricatori retrattili
Loading chutes



TC_
Trasportatori a coclea
Screw conveyors

Over
30
Years of service



YM
YOUNG-MASSA

YOUNG-MASSA Srl

Via S. Maria, 5
20873 Cavenago Brianza (MB) - Italia
Tel: +39 0295019613
Fax: +39 0295019413
info@youngmassa.it
www.youngmassa.it